

Tools

Mot. 1368

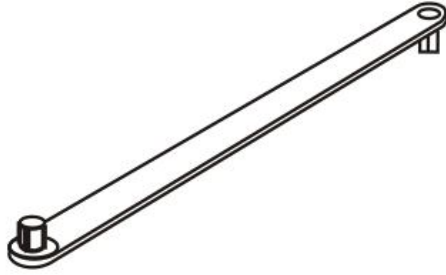

Mot. 1750

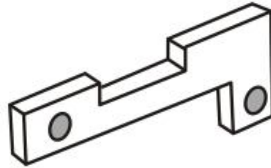

Mot. 1496

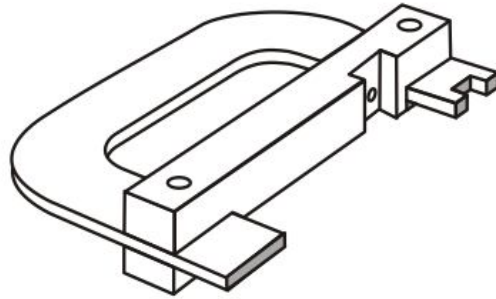

Mot. 1489



1. "MOT. :

- 1368" = Torx wrench
- 1750" = Camshaft locking tool.
- 1496" = Camshaft locking tool.

2. "MOT. 1489" = Crank locking tool.

Dismount 1

1. Remove :
 - the cover under the windscreen.
 - the battery and the battery case.
2. Dismount resonator.
3. Remove the air intake of the air filter.
4. Dismount air filter housing.
5. Remove :
 - the throttle housing.
 - the right front wheel.
 - the right inner fender.
 - the multi-belt.
6. Dismount right engine suspension.

Dismount 2

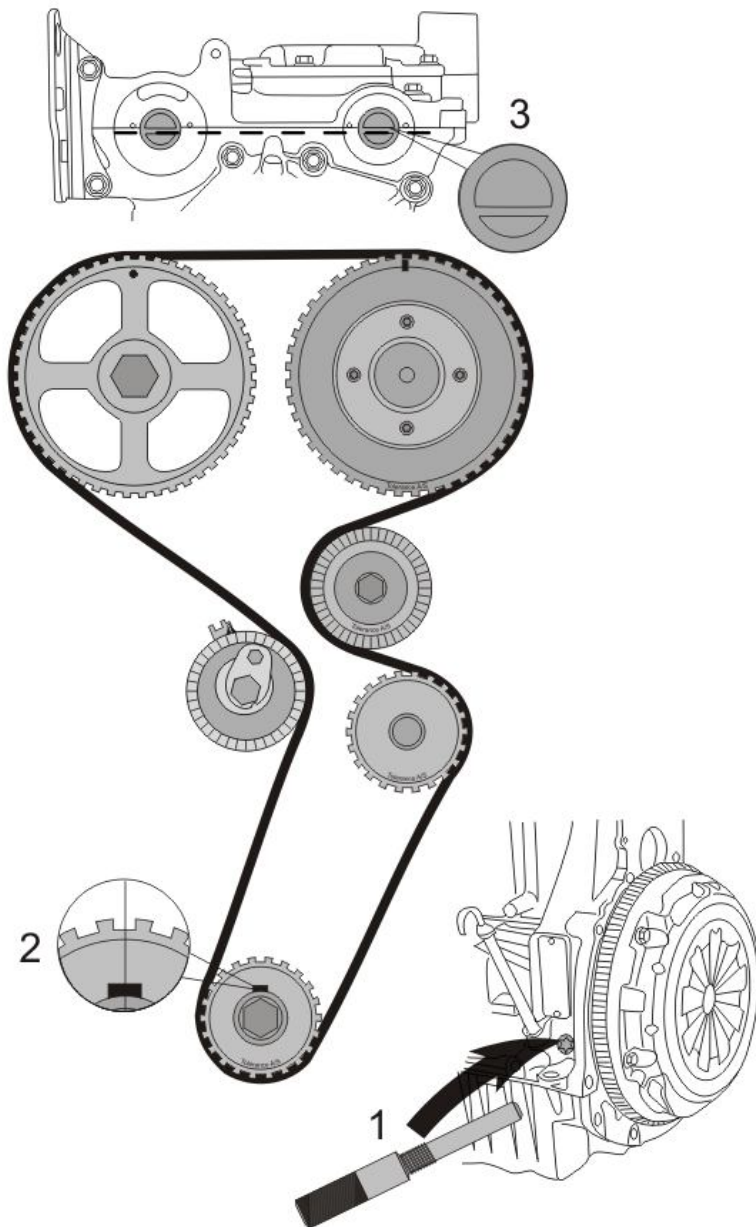

1. Note: The engine can be fitted with two different types of camshaft wheels!!!
2. -----
3. Remove the packing block at the rear of the camshafts.
4. Rotate crankshaft to approx. 10° before compression TDC on cylinder 1.
5. Remove the TDC pin plug from the engine, using a torx socket.
6. Fit tool Mot. 1489", and turn the engine slowly clockwise until the counterweight of the to the crankshaft on cyl. 1 goes counter.
7. Control markings.
8. Note: There is no peg in the crankshaft sprocket.
9. Remove the crankshaft pulley / vibration damper, use a screwdriver to block the flywheel.
10. Tighten the old crankshaft accessories pulley bolt fitted with a spacer onto the crankshaft.
11. Dismount :
 - upper timing belt cover.
 - lower timing belt cover.
12. Loosen belt tensioner.
13. Dismount :
 - idler pulley, use "MOT. 1368".
 - timing belt.
 - belt tensioner.

Mounting 1

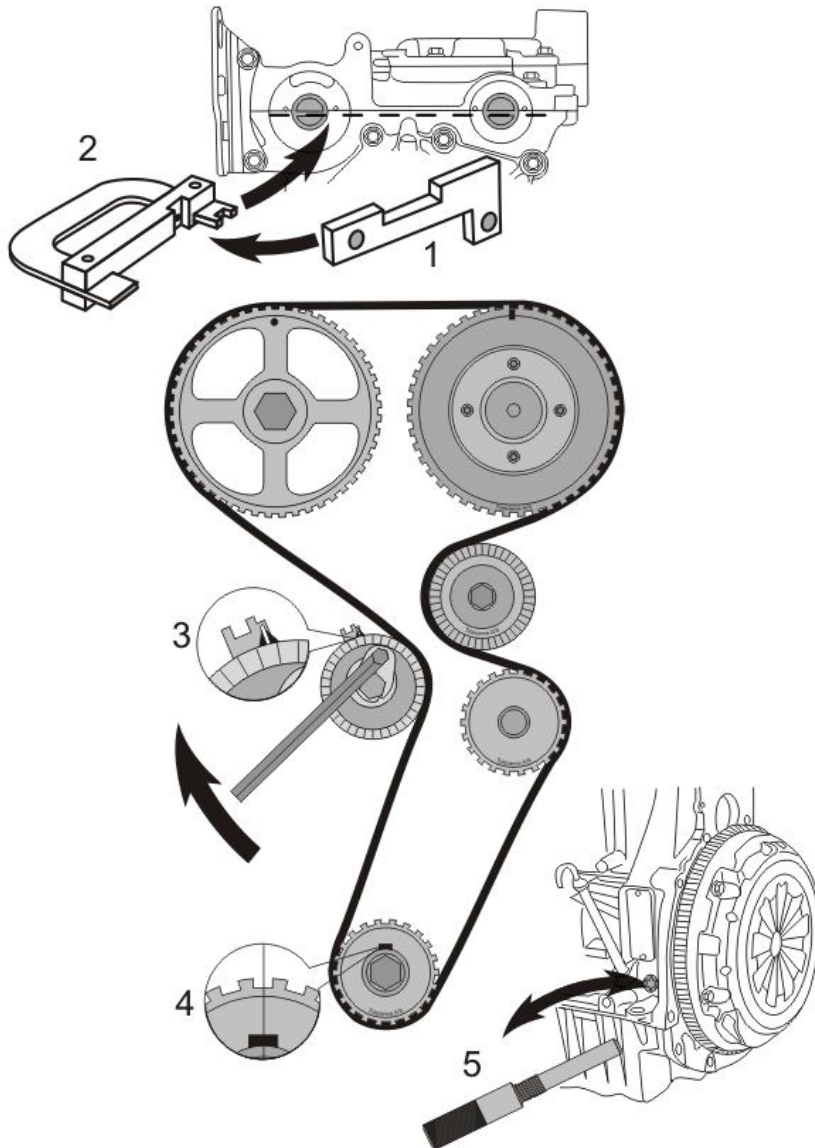

1. Fit tool Mot. 1496" to close the camshafts at the rear of the camshafts.
2. Check that the sprocket key on the crankshaft should be at the top.
3. Install :
 - new tensioning roller, checking that: the cylinder head groove is between the two roller lugs.
 - new tensioner roller.
4. Tighten 45 Nm.
5. Turn belt tensioner clockwise, until marks are aligned
6. Tighten 10 Nm.
7. Mount lower timing belt cover.
8. Tighten bolts 12 Nm.
9. Dismount crank bolt.
10. Check that the crankshaft is in contact with the locking tool "MOT. 1489".
11. Install the crankshaft pulley / vibration damper, tighten 40 Nm + 145° (use new bolt).
12. Remove :
 - the hatch in the timing belt cover.
 - locking tools "MOT. 1489" and "MOT. 1496".
13. Turn crankshaft 720°.
14. Fit :
 - tool Mot. 1489", and turn the engine slowly clockwise until the counterweight of the to the crankshaft on cyl. 1 goes counter.
 - tool Mot. 1496" to close the camshafts at the rear of the camshafts.
15. Control markings.
16. Tighten belt tensioner 27 Nm.

Mounting 2

1. Install the hatch in the timing belt cover.
2. Remove locking tools "MOT. 1489" and "MOT. 1496".
3. Mount plug for locking of crank in TDC.
4. Tighten 20 Nm.
5. Mount upper timing belt cover.
6. Tighten 41 Nm.
7. Fit new packing blocks at the rear of the camshaft.
8. The remainder is assembled in opposite order.