

Fuel level sensor



Warning

Dismantling the fuel reservoir (incl. fuel level sensor) involves work on the car's fuel system. The following points must therefore be observed in conjunction with these measures:

- Ensure good ventilation! If there is approved ventilation for extraction of fuel fumes then this must be used.
- Wear protective gloves! Prolonged exposure of the hands to fuel can cause irritation of the skin.
- Have a fire extinguisher suitable for flammable liquids and electrical equipment at hand! Be aware of the risk for sparks, i.e. in connection with circuit breaking, short-circuiting, etc.
- Absolutely No Smoking!
- Wear protective glasses.

Important

Be particularly observant regarding cleanliness when working on the fuel system. Loss of function may occur due to very small particles. Prevent dirt and grime from entering the fuel system by cleaning the connections and plugging pipes and lines during disassembly. Use 82 92 948 Plugs, A/C system assembly. Keep components free from contaminants during storage.

To remove

1.

Remove the fuel tank. Refer to [Fuel tank, To remove](#).

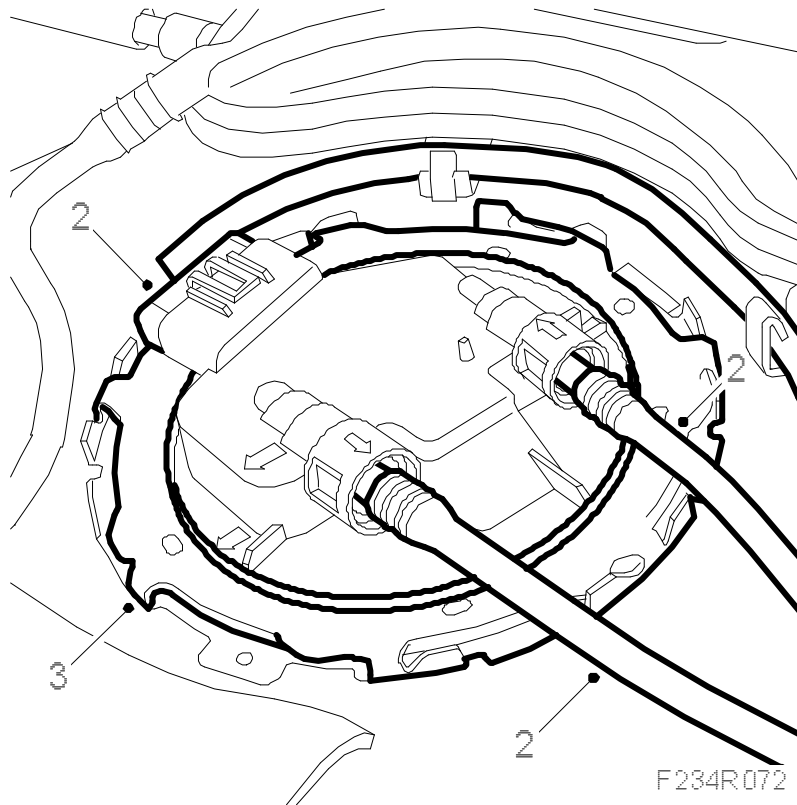

2. Remove the fuel lines and connector from the fuel pump cap.
3. Undo the cap's lock ring anticlockwise.
4. Lift up and move aside the cap.

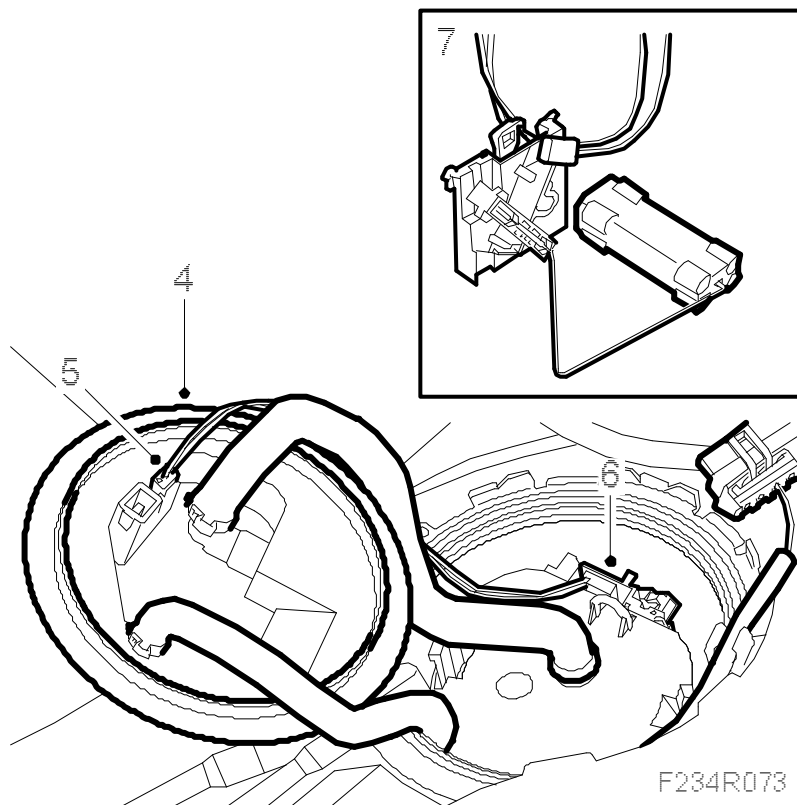

5. Remove the connector for the fuel level sensor from the cap.
6. Release the catch and remove the fuel level sensor from the filter housing.
7. Carefully remove the fuel level sensor from the tank.

To fit

1. Fit the fuel level sensor into the filter housing and plug in the connector.

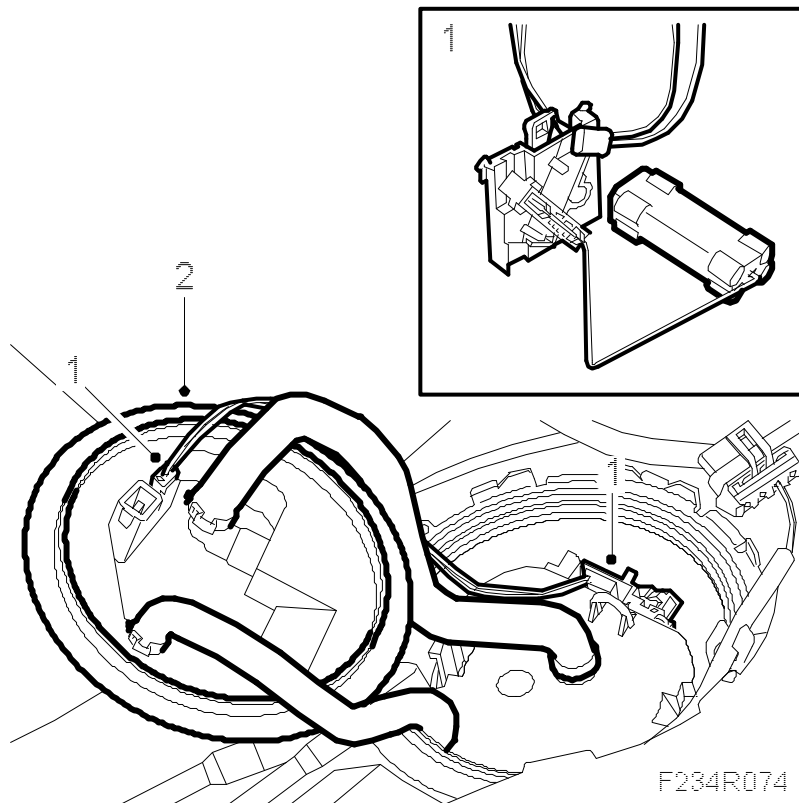

2. Fit and check that the new gasket lies in its groove. Fit the fuel pump cover.
- 3.

Fit the lock ring to the cap, tightening clockwise.

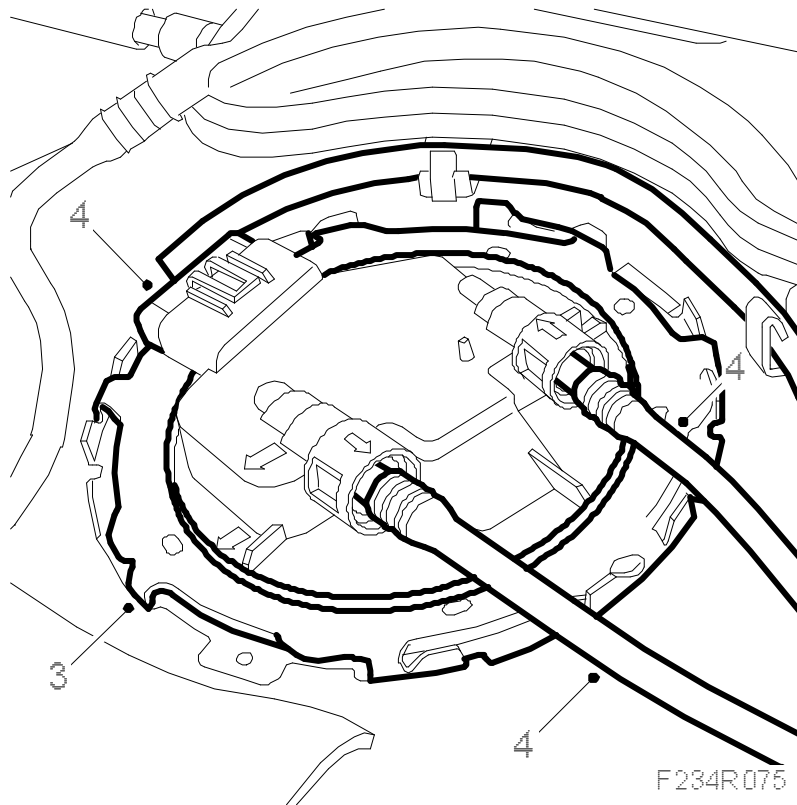

4. Connect the fuel lines and connector.
5. Fit the fuel tank. Refer to [Fuel tank, To fit.](#)